

Bhuku

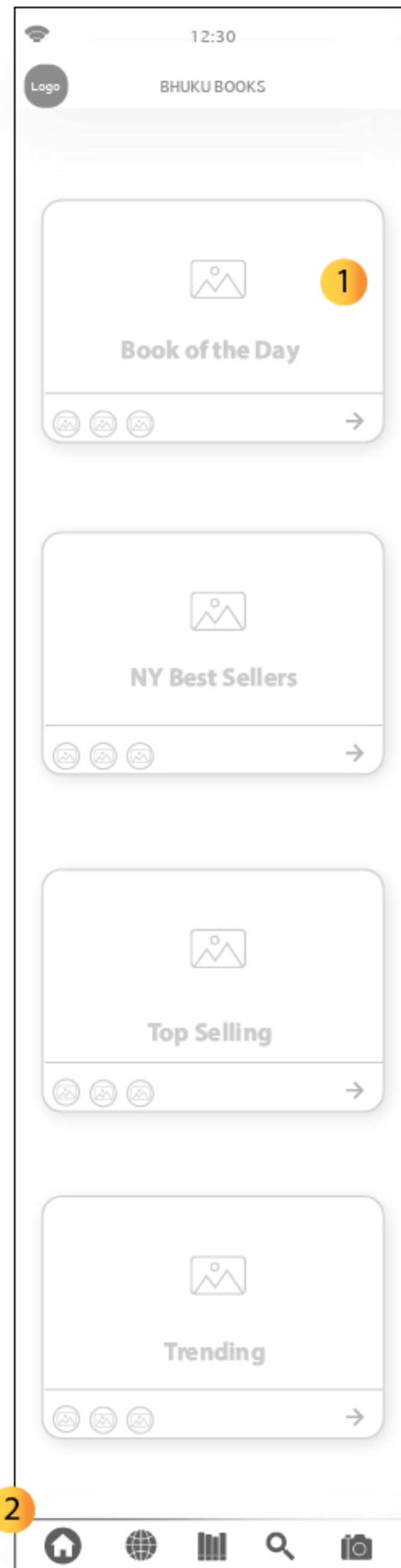

1 This page is the homepage, It has top highlights that the user would be interested in reading, based on the profile settings in the users account.

2 Here at the bottom of every page will be this navigation bar. Starting from left to right, its the homepage, the discover page, the users library, the universal search tool page and the scanner page for the user to scan and save books fast.

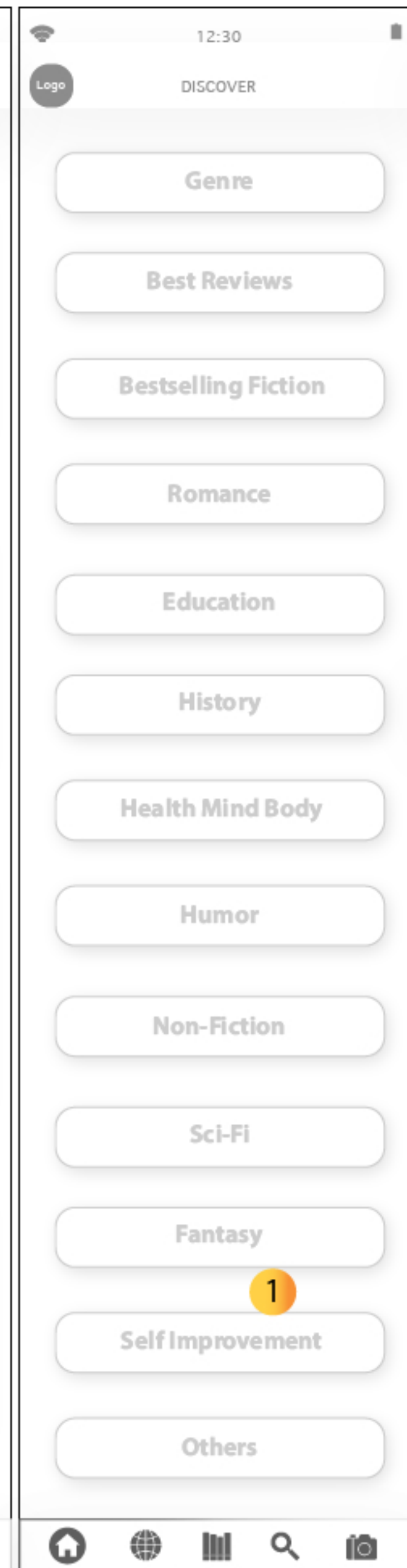

1 The discover page is list of pre created categories that Bhuku has created. Each button will lead the user to category screen of that title,

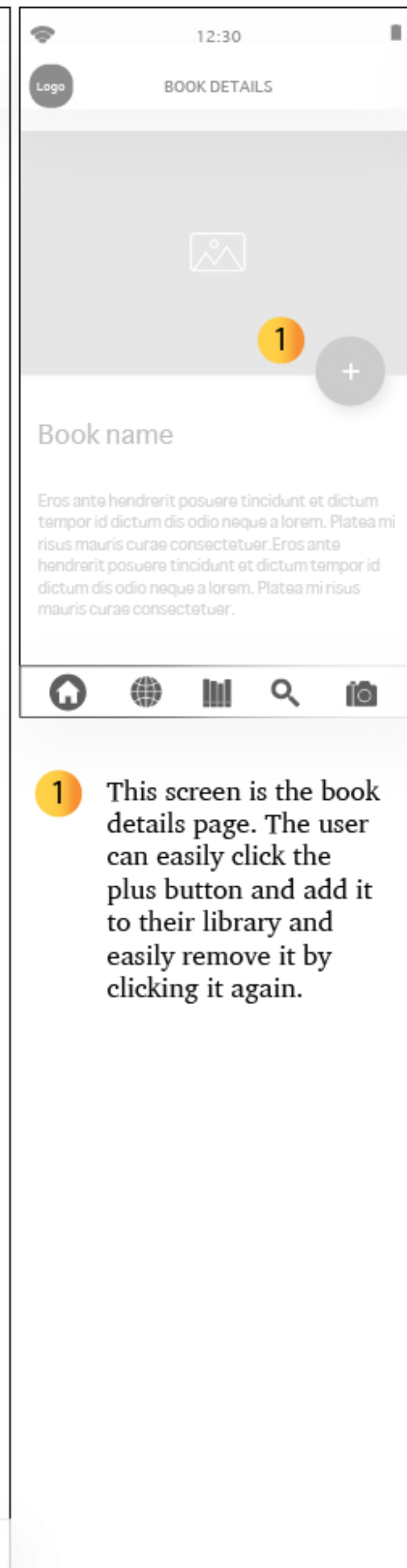

1 This screen is the book details page. The user can easily click the plus button and add it to their library and easily remove it by clicking it again.

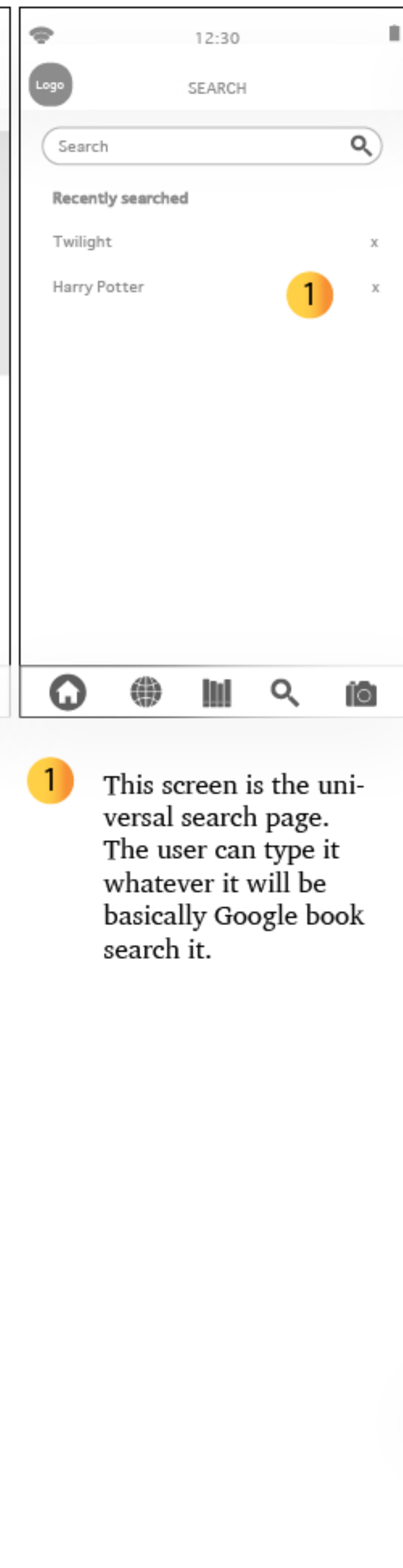

1 This screen is the universal search page. The user can type it whatever it will be basically Google book search it.

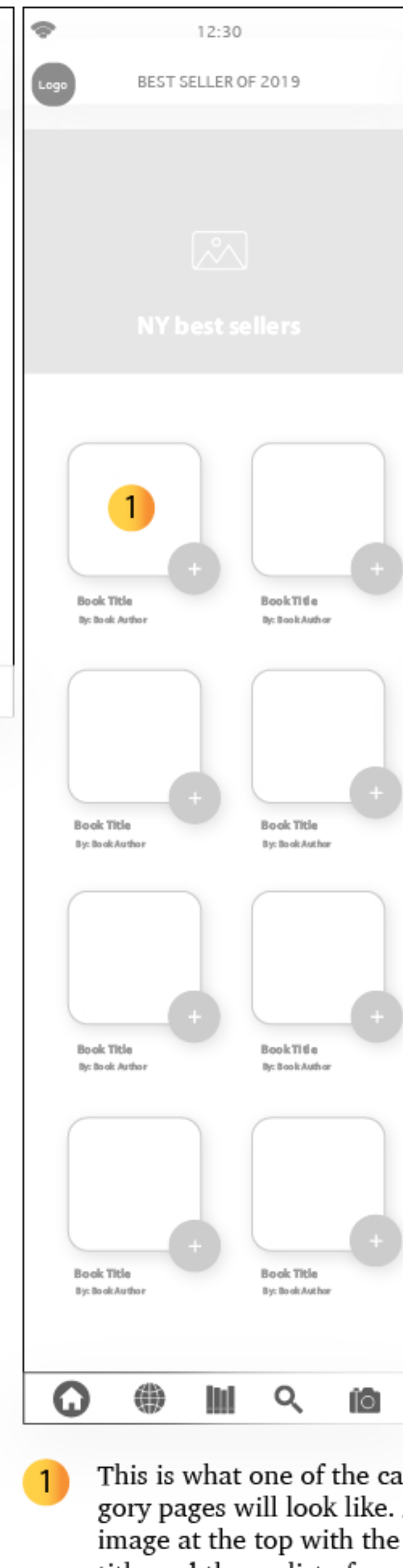

1 This is what one of the category pages will look like. An image at the top with the title and then a list of books, where the use will be able to click the book to view the details or they can click the plus sign to add it to their reading list.

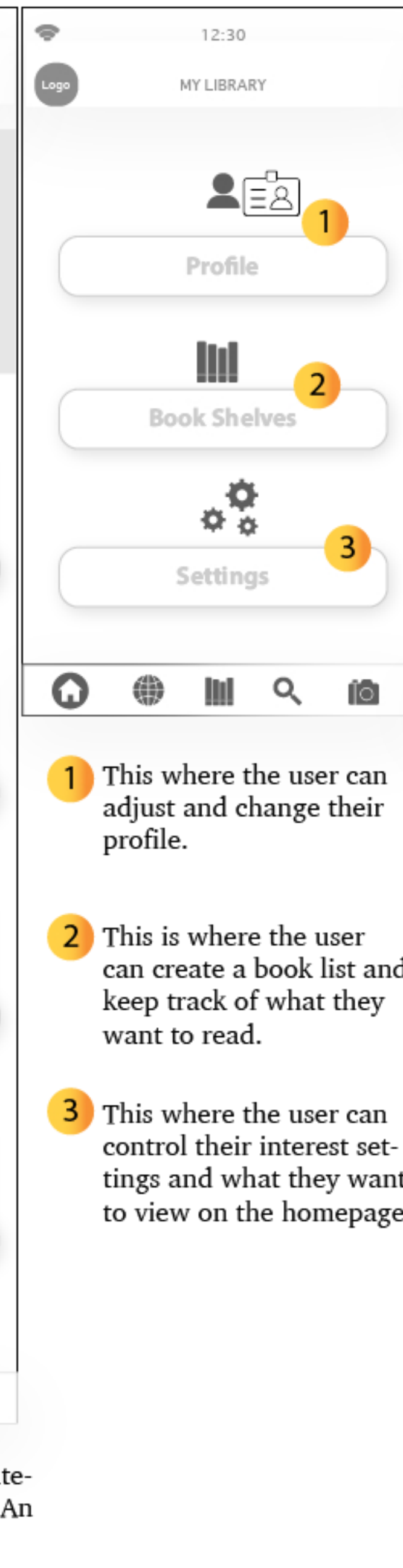

1 This where the user can adjust and change their profile.
 2 This is where the user can create a book list and keep track of what they want to read.
 3 This where the user can control their interest settings and what they want to view on the homepage.

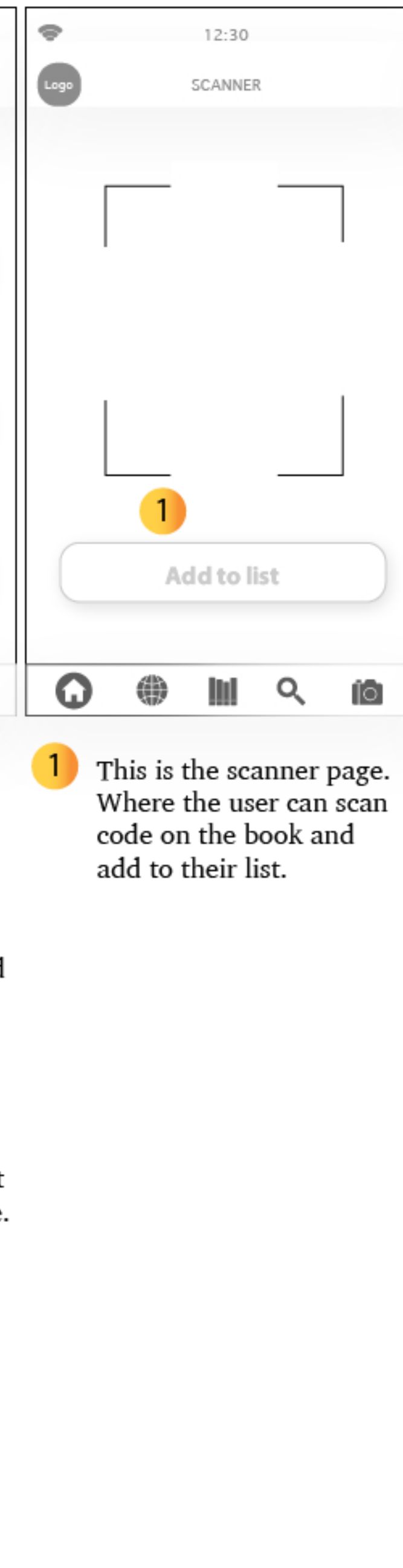

1 This is the scanner page. Where the user can scan code on the book and add to their list.

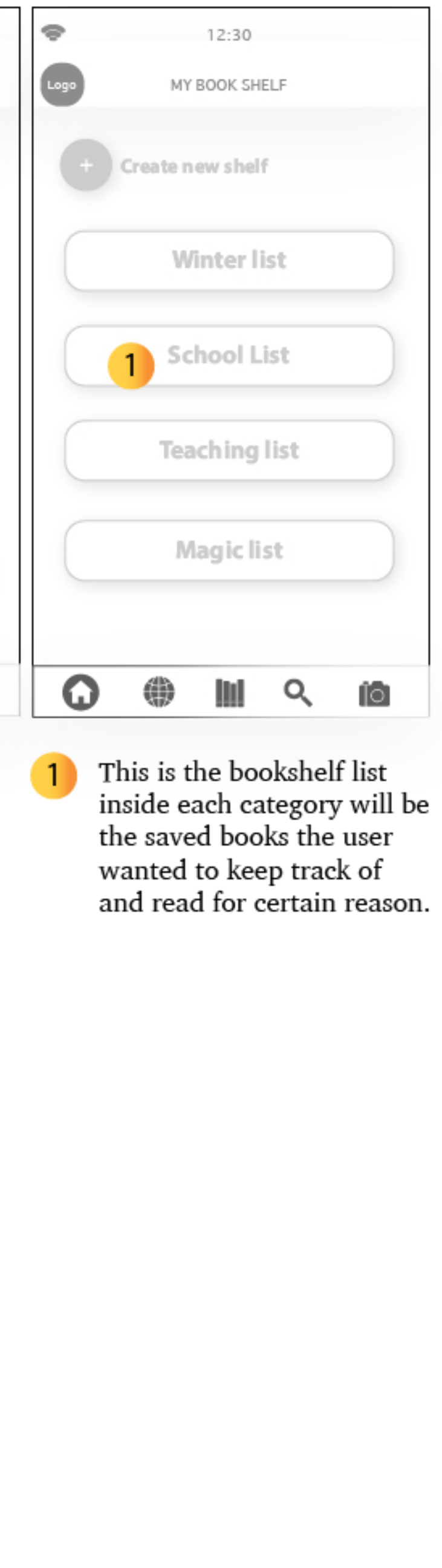

1 This is the bookshelf list inside each category will be the saved books the user wanted to keep track of and read for certain reason.